

1. System Introduction

This system uses WIFI + 4G telephone network dual network transmission. When an alarm occurs, the host pushes the alarm information to the user's mobile phone APP, and can also send text messages and make calls to the mobile phone. The dual network is safe and reliable. The user can actively control the host remotely through the APP.

1.1 Functional Features:

- (1) APP supports Apple and Android systems.
- (2) Bluetooth network configuration, faster and more stable!
- (3) There is no limit to the number of alarm hosts that can be bound to each smartphone; each user of the alarm host can log in through administrator or general member mode, of which the administrator is limited to one person and the number of general members is unlimited.
- (4) Can set 5 groups of SMS alarm numbers and 5 groups of phone alarm numbers.
- (5) Supports 99 wireless defense zones, 30 fire defense zones, 8 emergency call defense zones, 8 medical rescue defense zones, 4 water leakage defense zones, and can be equipped with 20 remote controllers or access control keypads (the remote controller can also be used for emergency alarm); 4 wireless sirens can be configured.
- (6) Scan the QR code to add wireless accessories to the host, accurate, convenient and fast.
- (7) The default setting includes seven languages and voice switching (Chinese, English, Russian, Spanish, French, German, Italian).
- (8) Two-way intercom function;

- (9) Timed arming, timed disarming and timed stay function (each timer can be set for three groups of time);
- (10) WIFI failure and telephone network failure prompt function;
- (11) Door and window open reminder function;
- (12) Detector low battery prompt function, detector offline prompt function
- (13) Supports delayed alarm function, delayed arming and delayed disarming function (0-99 seconds optional);
- (14) When the host alarms, the siren sounding time can be selected (0-254 seconds or always sounding);
- (15) In addition to the APP, you can also remotely control the arming and disarming of the host by SMS or dial buttons during a phone call;
- (16) The host has the function of staying on defense (only valid for intrusion defense zones 1-99);
- (17) Can record 10 seconds of alarm voice;
- (18) External power failure/recovery alarm function (optional to turn on or off);
- (19) Remote arm/disarm siren sound prompt function (optional to turn on or off);
- (20) Remote controller arm/disarm SMS reminder function (optional to turn on or off);
- (21) Door and window opening/closing reminder function in disarmed state (optional to turn on or off).

1.2 Technical Parameters:

(1) Radio Frequency: 433.92MHz

FM Mode: ASK

Transmit Power: 10db

Radio Distance: $\leq 120\text{m}$ (Open space)

(2) 4G Frequency:

LTE-FDD: B1/B3/B5/B8 B2/B3/B4/B5/B7/B8/B28/B66

LTE-TDD: B34/B38/B39/B40/B41

(3) Working Power Supply:

Power Input: DC5V/2A (type-c connector)

Standby Power: $\leq 1\text{W}$

Alarm Power: $\leq 2\text{W}$

Backup Battery: DC3.7V/1000MA

Standby Time: ≤ 8 hours

(4) Working Conditions:

Temperature: $-20 \sim +55^{\circ}\text{C}$

Humidity: $\leq 85\%$ No Condensation

(5) Built-in Siren Alarm Volume: $\geq 80\text{db}$

(6) Dimensions: 145mm(Longth) \times 145mm(Width) \times 30mm(Thickness)

(7) Housing Material: ABS

2. Host Structure Introduction

A. Back

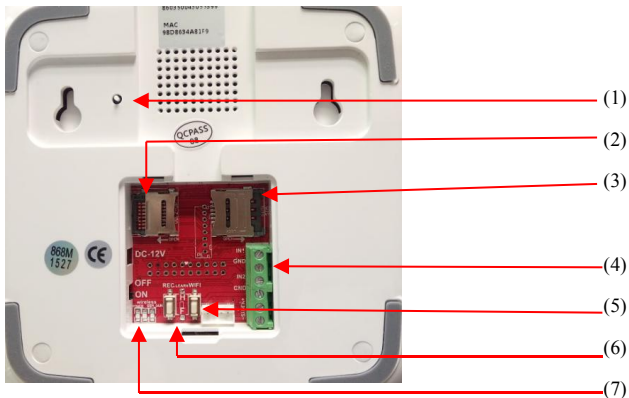

(1) Tamper Switch, must be installed with a wall-mounted bracket to serve as a disassembly alarm.

(2) SD Socket, used for device firmware upgrade.

(3) SIM Socket

(4)

(5) WIFI : APP Add Device Button

(6) REC: Recording Button

(7) **POWER(RED)**: Power Indicator Light, lights up when power is connected.

GSM_RUN(BLUE): 4G Network Indicator Light, flashing every 2 seconds means

signal failure and searching for network. Long light or fast flashing means network is normal.

Wireless(GREEN): Wireless Signal Indicator Light, used for production testing.

B. Front

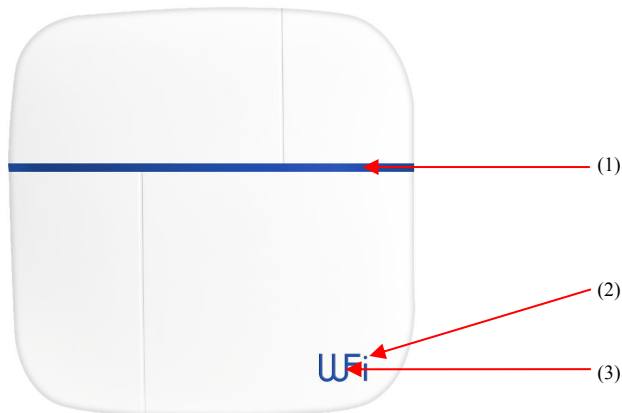

As shown in FIG:

(1) **Alarm Indicator (Red):** lights up when the device is turned on and in alarm, and flashes once when receiving SMS instructions or external power changes.

(2) **WIFI Signal (Blue):** When there is a signal, it flashes once every 400MS (0.4 seconds); when there is no signal, it flashes once every 2 seconds or is off.

(3) **Arm Indicator (Red):** When the light is flashing, it is delayed arming, when the light is always on, it means arming is completed, and the light is off when disarming.